



[BYNATURE]

Enjoy. Breathe. Feel good.



ByNature

SPECIALISTS IN BIOPHILIC DESIGN

We create strong connections between nature and the indoor environment



BYNATURE VISION

Nature plays an essential role in our lives by improving our wellness, happiness, health, and even our productivity. Yet, while we spend 85% of our time indoors, there is still an increasing lack of nature in our living spaces.

ByNature believes that any space could be transformed into a healthy living environment. We aspire to bring nature into everyone's lives by creating an experience for people to enjoy, breathe, and feel good.

BYNATURE MISSIONS

Whether small scale, large scale, living or preserved, ByNature's team of passionate people are dedicated to using their knowledge of biophilic design principles to liven your home or office space.

ByNature's vision, however, could not happen without its growing network of visionary partners (architects, designers, landscapers, engineers, and creative visionaries alike). Together, we bring our unique expertise to the table to promote, educate and innovate by creating and sourcing new leading-edge technologies that make your living space a better place.

ENJOY. BREATHE. FEEL GOOD.

TABLE OF CONTENT

Mossart	5
Reindeer moss	12
Sheet Moss	14
Pole Moss	15
Fern moss	16
Mood moss	16
Folia	17
Bulk Preserved Plants & Flowers	20
Modulogreen®	22
Live Systems	28
Felt Pockets	32
Wallflower® Living Frames	35
ByNature Self-Watering Planters	37
Custom Planters	38
Home Decor	39
Greenturn®	40
Magnetized™ Collection	41

PRESERVED

Our plants and mosses are preserved in an innovative and eco-friendly way using 100% natural oils and food dye. This allows the plants to maintain their authenticity without the need for maintenance.

From Mossart walls to Folia frames, ByNature prides itself in supplying a large range of preserved products to fulfill any creative endeavour.



MOSSART

Our Mossart creations are 100% natural and made with preserved moss. Mossart products are no longer living and do not require any maintenance, trimming, nor watering.



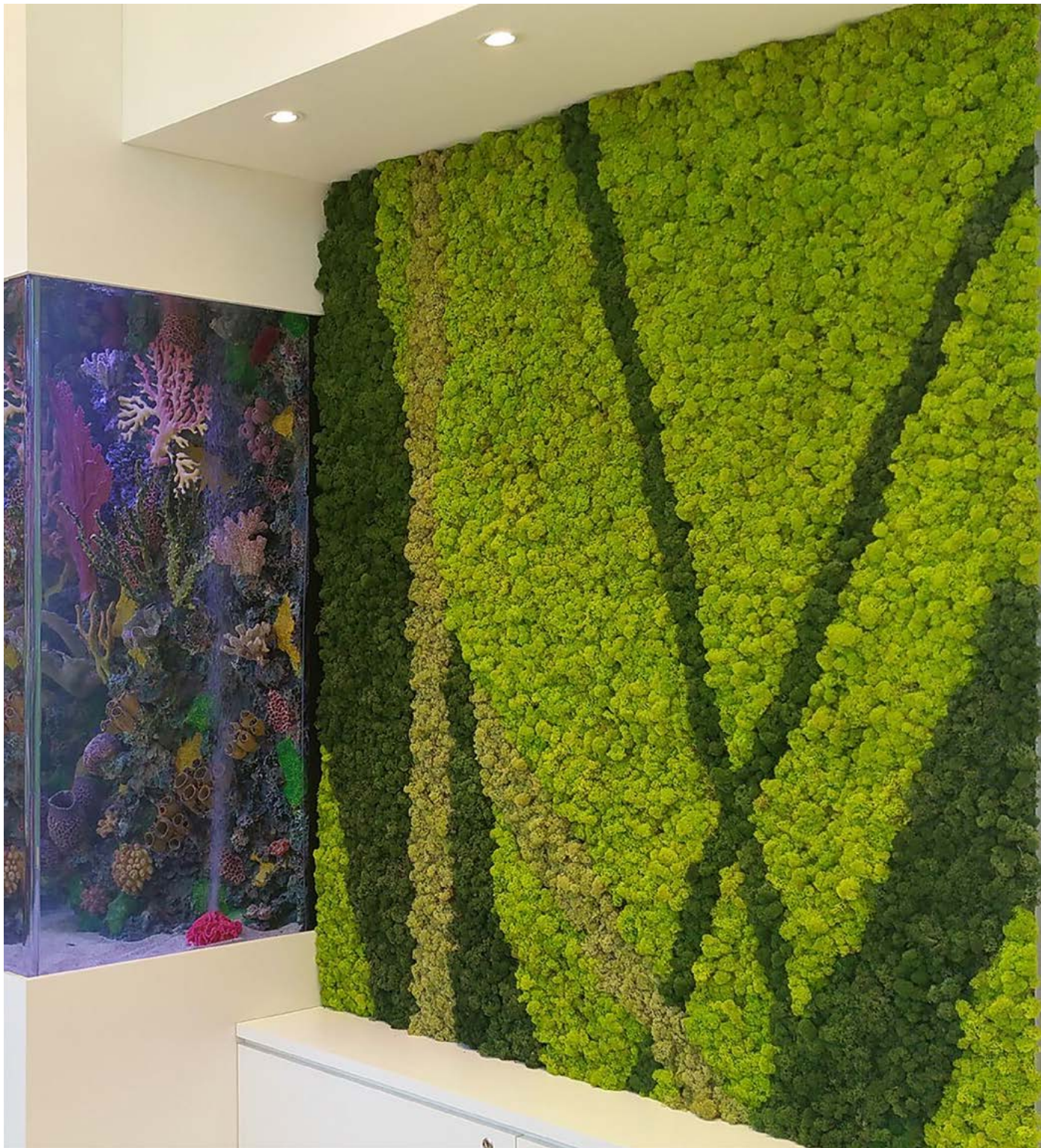

WHAT IS A PRESERVED MOSS?

Mossart creations are made with 100% natural mosses that require no watering, light or trimming.

Harvested according to ecological practices, the moss is preserved by replacing the water in the plant with glycerine. As there is no longer any water in the plant, it will never dry out and will maintain its natural texture.

HOW TO MAINTAIN A PRESERVED MOSS?

Mossart is an indoor-use product only and its softness may vary according to the relative humidity of the room. In the case of a very dry environment (below 30% humidity), the moss may dry out but you will find that it will become soft again if placed in a room with proper relative humidity or when the relative humidity goes back to normal. This variation is usually related to the season. A relative humidity considered as "normal" is usually between 45 and 65%.

When soft, the moss should never be watered or sprayed. Be aware that the "softness state" of the moss does not change its look, it will always look green, fresh and natural. You will experience a natural scent for a few months, which will progressively fade. The Mossart product should never be placed in direct sunlight as the colour may fade. If required, the moss could be carefully dusted using a blow dryer on a low temperature setting.



MOSSART PANELS INSTALLATION ON A WALL

PANEL INSTALLATION

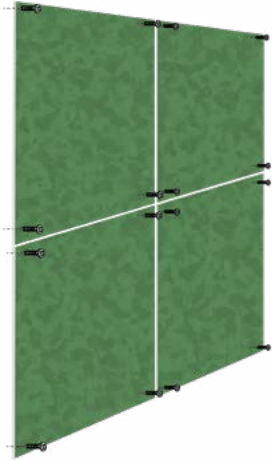

- Pre-made panels (2 inch thick)
- Simply screw panels in place
- Custom sizes and shapes
- Seamless look

BACKING OPTIONS



coroplast



cork



felt



wood

STANDARD PANEL SIZES

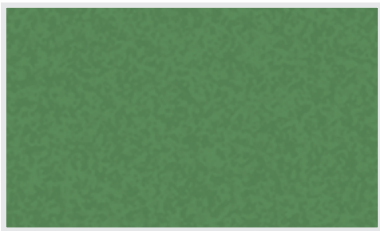

3ft x 5ft

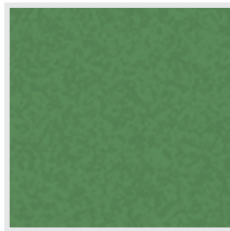

3ft x 3ft



26in x 20in



3ft x 1ft



1ft x 1ft

Bulk moss, as well as customized logos and products are available upon request.



custom logo (by Off the Wall Greenscapes)

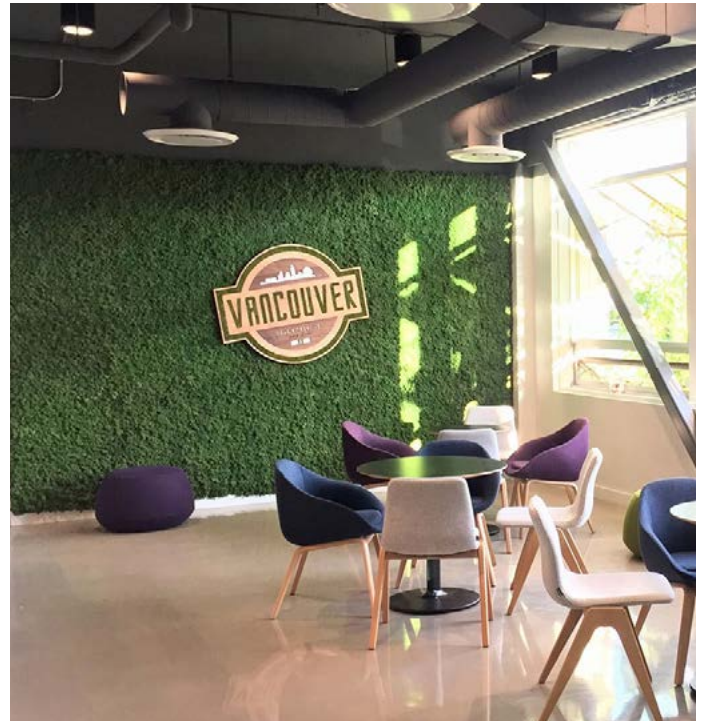

custom logo (by Terra Landscaping)



custom logo (by Greenery)

MOSSART IN A FRAME



ByNature Design

STANDARD FRAME SIZES

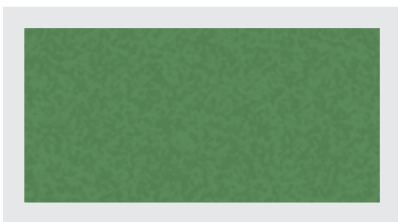

24 x 44 inch

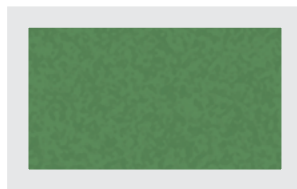

20 x 32 inch

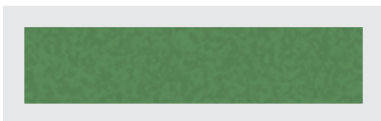

12 x 42 inch

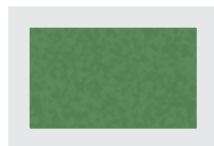

15 x 22 inch

STANDARD FRAME OPTIONS



white



cedar



black

Over 200 custom frame sizes and textures available.



mossart frames (by Vertical Garden Technology)

REINDEER MOSS

ByNature Reindeer Moss, actually a lichen, is our most popular moss for both large and small applications. From natural to bold shades, Reindeer Mossart comes in 17 different colours that create unique and lush designs.



Dark Green

2 TEXTURE OPTIONS

Grade A
higher quality using only the top part of the moss



Grade B
made with top and bottom part of the moss





Orange



Burgundy



Charcoal



Red



Grass Green



Silver Grey



Ice Blue



Spring Green



Mint



Natural



Olive



Yellow

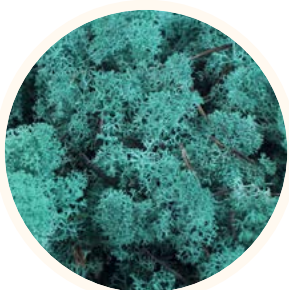

Pacific Green



Pink



Purple



Blue Lavender



ACOUSTIC FUNCTION

Mossart Wall Panels have significant sound-absorption.

According to a study conducted by the Centre for Architectural Ecology at the British Columbia Institute of Technology (BCIT), sound absorption is relatively high with signal number ratings (NRC and SAA) in the range of a 3/4"-1" fibre board, or a carpet on underlay pad.

Absorption in this range can be useful in classrooms and conference rooms to improve speech intelligibility and the quality of verbal communication.

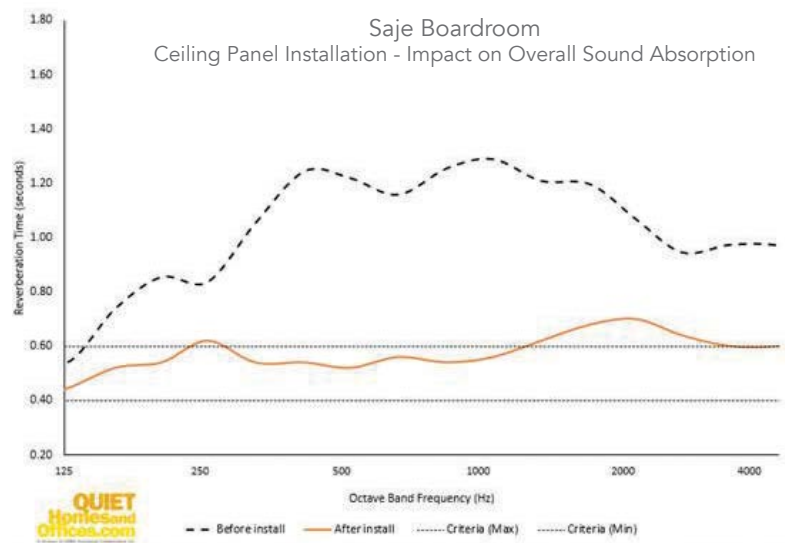



SHEET MOSS

ByNature Sheet Moss brings a very natural and organic feel to a space. Sheet moss can be used to create original décor and is often applied as a wall or ceiling covering. It exists in one colour only. Standard panels are approximately ¼" thick.



PRESERVED SHEET
MOSS DARK GREEN



PRESERVED SHEET
MOSS LIGHT GREEN



DRIED SHEET MOSS

POLE MOSS

ByNature Pole Moss brings a chic and modern look to any space. Pole moss can be used to create original décor and is usually used in wall or ceiling coverings. It exists in one colour only. Standard panels are approximately 2" to 3" thick.



POLE MOSS DARK GREEN



POLE MOSS LIGHT GREEN



MINI POLE MOSS



(by Greenstems)

FERN MOSS

~ ½" thick – comes in dark green only



MOOD MOSS

~2" to 3" thick - comes in medium dark green only



(by Greenstems)



FOLIA

ByNature's exclusive line of 100% natural preserved plants can be used to create an endless possibility of designs; from centre tables to unique frames and wall creations. This natural décor will last for years and will not require any maintenance (no natural light, trimming or water required).

- No maintenance, water or light required
- Long lasting preserved natural décor
- No size or design limitations
- 70+ plant varieties available
- 20+ flower varieties available
- 100% natural

AVAILABLE FORMATS

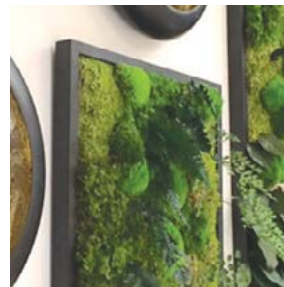

FRAMES



WALLS



BULK FOLIAGE



CUSTOM



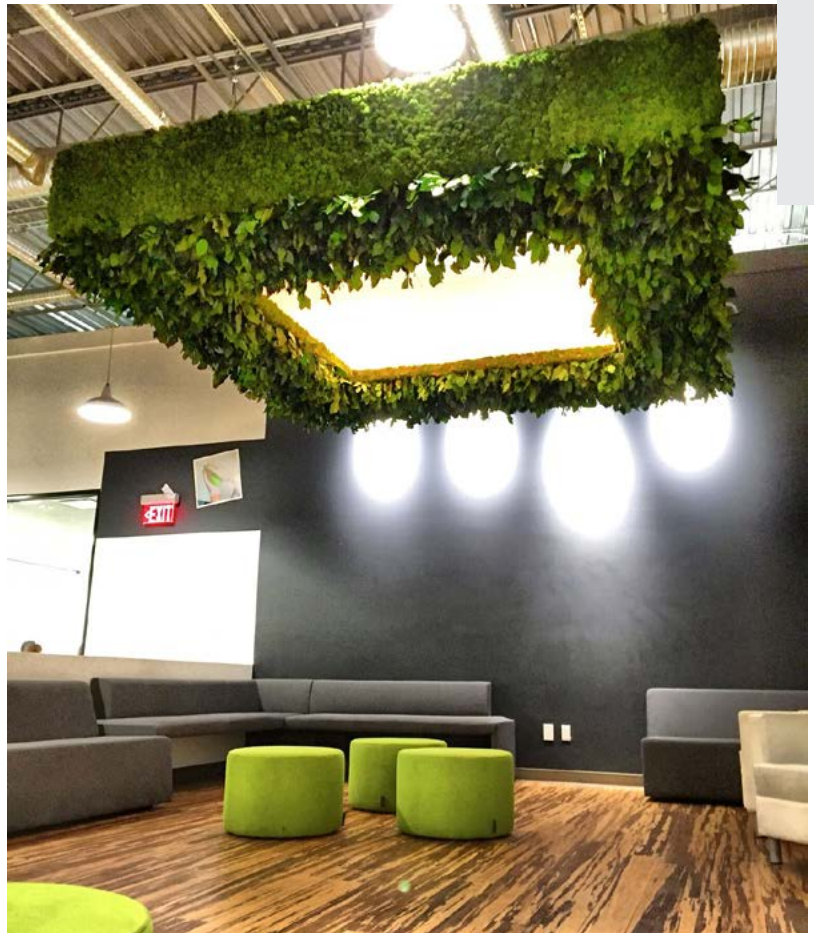

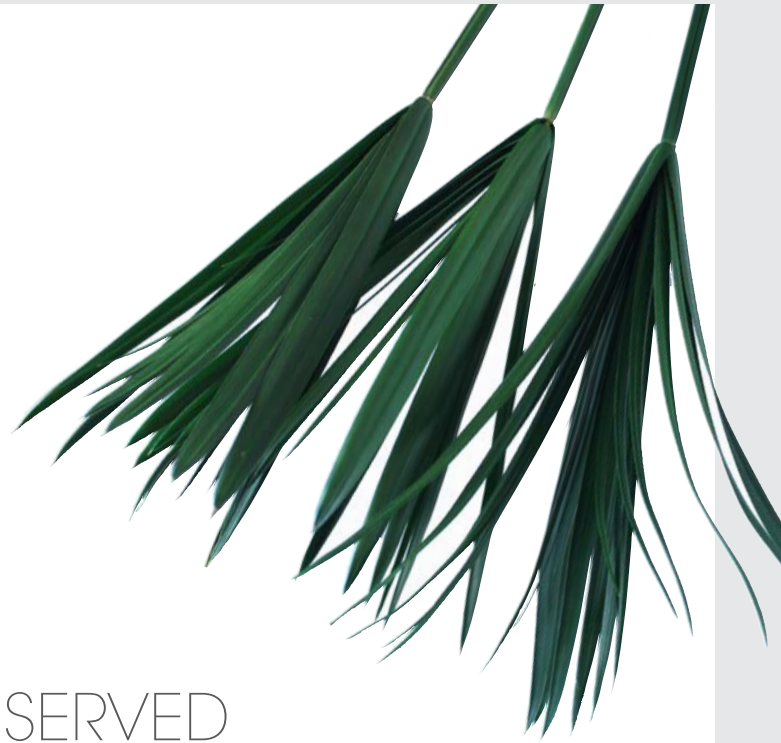

BULK PRESERVED PLANTS & FLOWERS

REQUEST OUR CATALOGUE OF PRESERVED
PLANTS AND FLOWERS

INFO@BYNATUREDESIGN.CA



LIVING WALL SYSTEMS

Living walls are vertical gardens that bring life to both the indoor and outdoor space. Self-sustained in specifically engineered systems, living walls can help purify the air and enhance well-being.

At ByNature, we offer varied systems, depending on the application, that can be customized as part of the building envelope or simply serve as living art.



MODULOGREEN®

Plants thrive when they grow in rich, natural soil with access to regular light and water. That's why we designed the ModuloGreen® Living Wall which comes with a special substrate to ensure optimal plant growth, low maintenance and water consumption requirements. ModuloGreen® Living Walls are also easy to install and one of the most cost-efficient for both you and the environment.

MODULE SIZES & FEATURES

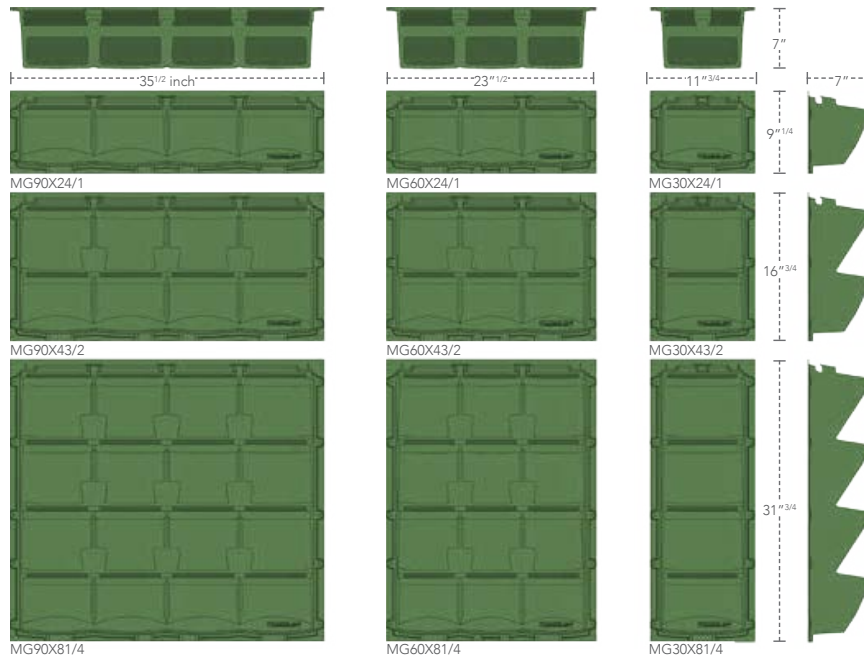

- low cost
- biodiversity
- low maintenance
- wall protection
- phonic absorbent
- sustainable
- energy saving
- low in water consumption
- easy installation
- large plant diversity
- easy planting
- recyclable
- engineered growing medium
- C2C® certified



ModuloGreen® Living Wall is the first Cradle-to-Cradle certified living wall system in the world. Made from recycled plastic and recyclable after use, the smart design of the module also evenly distributes and circulates water while optimizing the system's water consumption (220 litres / m² / year for an exterior living wall or 110 litres / m² / year for an indoor wall).



PANEL INSTALLATION

Modulogreen® green walls are mounted using a wide diversity of methods and materials with the idea of keeping installation easy. Traditional studs can be used for small indoor applications while engineered brackets can be used for outdoor large scale applications. Traditionally, air space between the wall and the living wall is created to limit the risk of condensation.

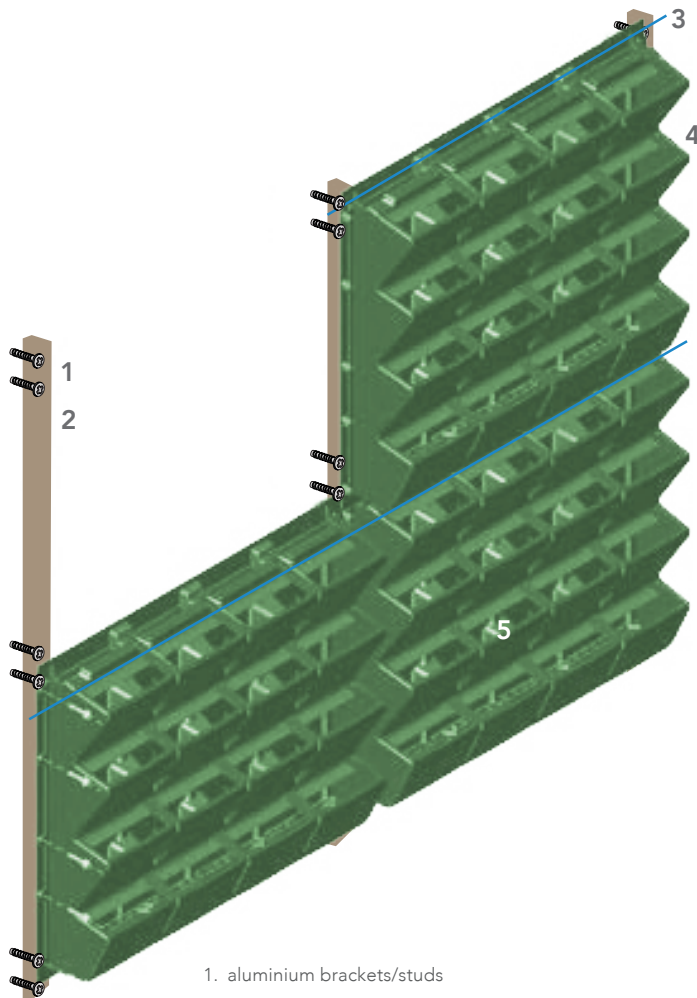

1. aluminium brackets/studs
2. stainless steel self-drilling screw/anchors
3. self-regulating dripline
4. planting cells
5. filter

WATER DISTRIBUTION

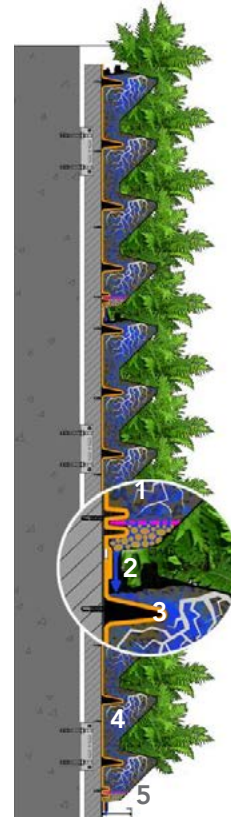

1. filter + draining layer
2. drainage holes
3. internal water distribution
4. growing medium
5. collecting gutter

IRRIGATION



1. controller
2. valves (variable numbers)
3. fertilizer injector mounted in by-pass
4. filter
5. pressure regulator with gauge
6. Check valve
7. water inlet (disconnected)

Proper irrigation of a green wall requires a dedicated water supply. Ideally, a living wall system should be plugged into the main water supply with an automatic irrigation system (pictured on the left) or irrigated with rainwater (if outdoors). If there is no access to water, a reservoir connected to a pump and timer assembly can be installed or hand watered.



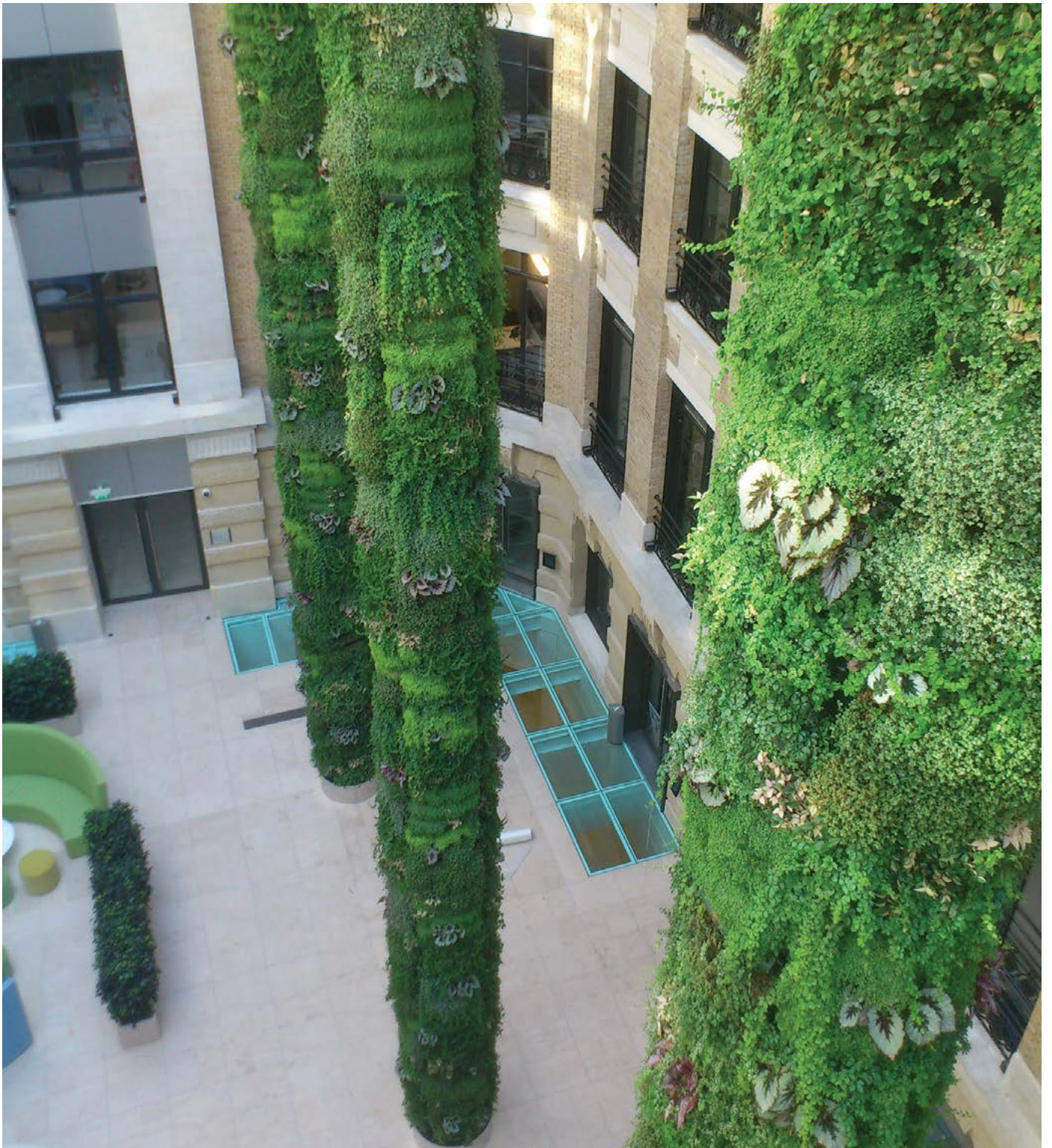



LIVE SYSTEMS

All Live Systems use a cloth wick to deliver water to the plants, so there is no need for pumps, drip lines, electricity or plumbing.

- Low maintenance; water once every 4-6 weeks
- Easy installation - no plumbing or electricity required
- Lightweight system can be installed directly onto drywall
- Easy cassette replacements and seasonal rotations
- Interchangeable plant cassettes
- Wicking irrigation system
- Customizable frames

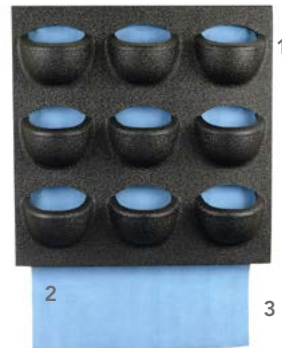

SYSTEM

1. cassette
(9 four inch plants each)
 2. cotton wick
 3. gutter/reservoir
- 15.75 x 15.75 x 3.5 inch





live panel



live picture - charcoal



live divider



live picture XL - silver



LIVEPICTURE 1
 28.5 x 28.5 x 2.75 inch - 26.5 lb
 holds 9 plants

LP-1-S
 LP-1-C
 LP-1-W



LIVEPICTURE 4
 76 x 28.5 x 2.75 inch - 56.0 lb
 holds 36 plants

LP-1-S
 LP-1-C
 LP-1-W



LIVEPICTURE 2
 44.5 x 28.5 x 2.75 inch - 36.5 lb
 holds 18 plants

LP-2-S
 LP-2-C
 LP-2-W



LIVEPICTURE 3
 60 x 28.5 x 2.75 inch - 46.5 lb
 holds 27 plants

LP-2-S
 LP-2-C
 LP-2-W



LIVEPICTURE XL
 67 x 44.5 x 2.75 inch - 77 lb
 holds 54 plants

LP-XL-S



- » 54 four inch plants per side
- » 205 lb (single sided)
- » 282 lb (double sided)
- » 20 gallons water capacity

FREESTANDING LIVE DIVIDER

71 x 44.5 x 5.5 inch



LD-1-S

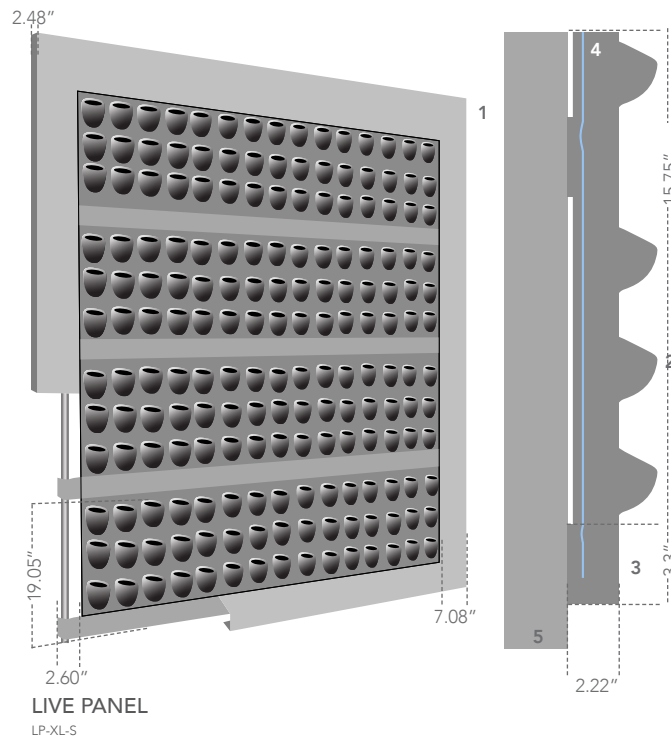

LIVE PANEL

LP-XL-S

- 1 decorative frame (optional)
- 2 plant cassettes
- 3 gutters - each gutter acts as the water reservoir for the row of cassettes above it. The bottom of the gutters have clips to secure the row of cassettes below it in place. The gutters are connected to one another on one end by a flexible hose system
- 4 cotton wick
- 5 wall

- » 4.5 plants per square foot
- » 8.2 lb per square foot (full with plants and water)
- » uses ~0.65 gallons of water per 10sf per week (varies depending on lighting & plants)

FELT POCKETS

The use of Felt Pockets is the most affordable way of creating living walls. Quickly and easily create lush green walls and vertical gardens on any indoor or outdoor wall, fence or railing. Design living walls of any shape or size by combining multiple pockets together.

- Affordable living wall solution
- Simple maintenance
- Easy installation

SYSTEM

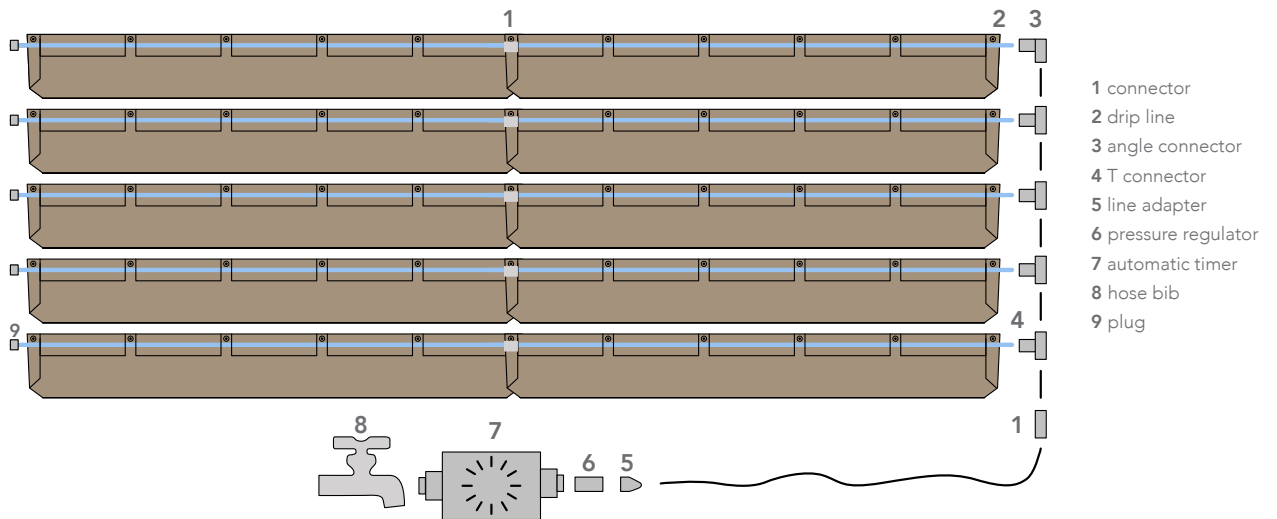

FELT ONE

15 x 24 inch



WA1BK WA1BR



FELT THREE

15 x 68 inch



WA3BK WA3BR



FELT FIVE

15 x 112 inch



WA5BK WA5BR



DECOR

ByNature offers a variety of ornamental products that allow to integrate greenery in spaces in a variety of ways. Though small, these products still have the potential to make a big statement.





WALLFLOWER® LIVING FRAMES

The Wallflower® Living Frame is a living piece of art that infuses any room with greenery. Suitable for walls and table tops, the Wallflower® uses a wick system that automatically irrigates plants from a self-contained reservoir.

- Fill the reservoir once a week
- Wicking irrigation system
- Water level indicator

SYSTEM

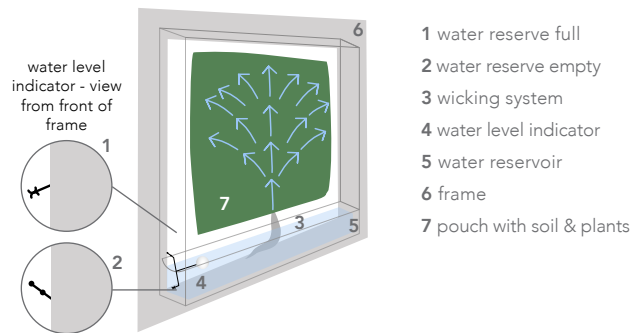



X-SMALL

6.7 x 6.7 inch



WFXSG WFXSR WFXSW WFXSB WFXST



SMALL

12 x 12 inch



WFSGR WFSRE WFSWH WFSGY WFSBL
WFSWG WFSOR WFSBA WFSKD WFSOW



MEDIUM HORIZONTAL

22 x 13 inch



WFMGR WFMRE WFMWH WFMGY WFMBL
WFMBA WFMCD WFMOW



LARGE HORIZONTAL

34.5 x 13 inch



WFLBA WFLCD WFLOW



MEDIUM VERTICAL

13 x 22 inch



WFMVBA WFMVCD WFMVOW



LARGE VERTICAL

13 x 34.5 inch



WFLVBA WFLVCD WFLVOW

custom colours for all sizes available upon request



FOR MORE
INFO, REQUEST
OUR PLANTER
CATALOGUE

BYNATURE SELF- WATERING PLANTERS

Our Self-Watering Planters allow you to have live plants without the maintenance of traditional planters. Various designs and sizes available for tabletop and floor.

- Fill the water reservoir once every 4 to 6 weeks (water from the top for the first 8 weeks)
- Floor and tabletop designs available
- Wicking irrigation system
- **Over 200 references**

SYSTEM

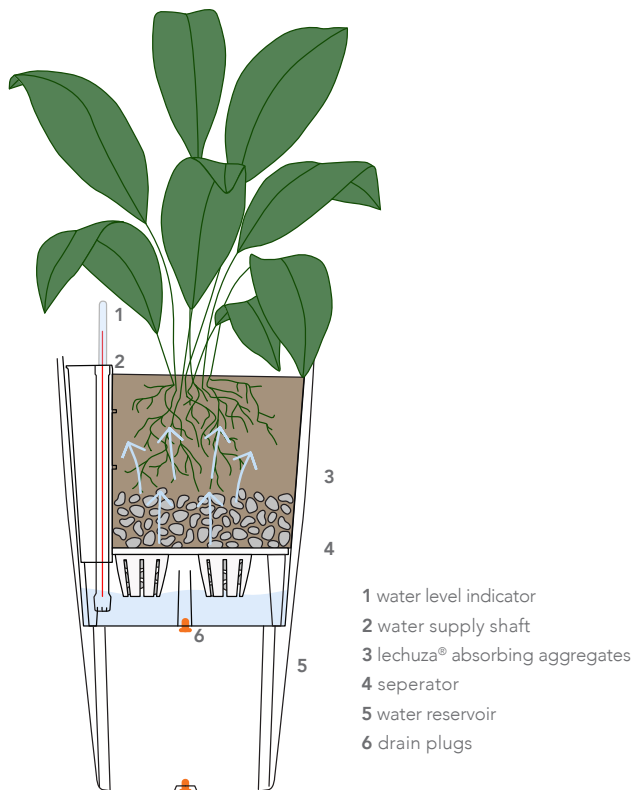

CUSTOM PLANTERS

ByNature is proud to announce that we can now accommodate your planter requests. We can customize (colors, shape and sizes) planters out of aluminum, stainless steel as well as fiber glass.

ByNature also supplies liners and self watering systems that can be integrated to any planters.

FOR MORE
INFO, SEND US
YOUR PLANTER
SPECS



HOME DECOR

ByNature's Home Decor collection provides innovative designs and concepts. This line ranges from zero (with preserved moss) to low maintenance (with succulent and air plant products).



LARGE MOSSART CANVAS

10 x 8 x 2.5 inch

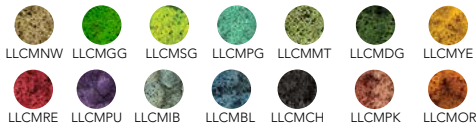

LLCMNW LLCMGG LLCMSG LLCMPG LLCMMT LLCMDG LLCMYE
LLCMRE LLCMPU LLCMIB LLCMBL LLCMCH LLCMPK LLCMOR



LARGE TROPICAL LIVING CANVAS

15 x 11.75 x 2.5 inch
LTLC



LIVE SHADOW

7.75 x 7.75 x 2.5 inch
LISH



LAYERS OF LIFE

4 x 4 x 12 inch



LLWH LLBL



AIR PENDANT

5 x 4 x 1.5 inch



APWH APBL



AIR NECKLACE

2.5 x 2.5 x 6 inch



AIME



LILY PAD

4.5 x 4.5 x 3 inch



LILPBL LILPWH



LILY FLOWER

3 x 2.5 x 2.25 inch



LILFBL LILFWH



PILLAR - 3 sizes available
small // medium // high

1.5 x 1.5 x 8.5 inch // 1.5 x 1.5 x 6 inch // 1.5 x 1.5 x inch



PVELG PVELW



LIVING LANTERN

5 x 5 x 9 inch

LILA



GEO BALL

5 inch diameter

LGEOB



MINI GEO BALL

3 inch diameter

MGEOB



GREENTURN®

The Green Turn is a versatile modular planter system that can be fitted together to create original combinations. With its anti-UV treatment, Green Turn can be secured to corner spaces on both interior and exterior walls. Use 1 module can be mounted in a corner, 2 modules on a flat wall and, or 3 modules to have a beautiful cascade of plants on an exposed corner or pillar.

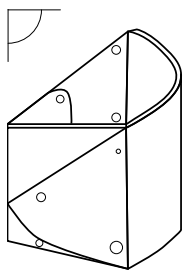

GREEN TURN - 1 MODULE

8.5 x 6 x 6 inch/unit



GT1BK GT1GR GT1RE GT1WH

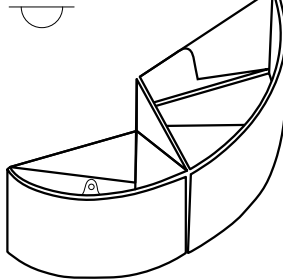

GREEN TURN - 2 MODULES

8.5 x 6 x 6 inch/unit



GT2BK GT2GR GT2RE GT2WH

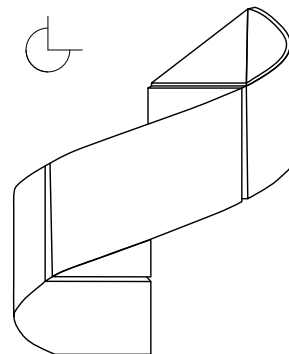

GREEN TURN - 3 MODULES

8.5 x 6 x 6 inch/unit



GT3BK GT3GR GT3RE GT3WH



MAGNETIZED™ COLLECTION

These Danish designed magnetic pots come in various colours and patterns. Able to stick to any metallic surface (appliances, shelves, lamps, etc.), they allow you to add small accents of nature in unusual places. Slightly water once a week.



GREEN



RED



ORANGE



BLUE

MAGNETIC CUBE

3 x 2.5 x 2.75 inch



SQUARE
4.5 x 4 x 2.5 inch



TEARDROP
5.5 x 3 x 2.5 inch



ROUND
4.5 x 4.5 x 2.5 inch

NEO CLASSIC
3 x 2.5 x 2.5 inch



WHITE



GREY



PINK



BLACK



LIGHT BLUE



RED



ORANGE



YELLOW



GREEN



DARK BLUE



DOT & SQUARE



LIGHT NORDIC



GREY SILENCE



WHITE SILENCE



LIGHT WOOD



DARK WOOD



GREY CONCRETE



DARK CONCRETE



ZEBRA GREEN



ZEBRA BLACK



ZEBRA RED

MAGNETIC SPHERE
3 x 2.5 x 2.5 inch



Nicolas Rousseau / President
nicolas@bynaturedesign.ca

Miriell Ko / Project Designer
miriell@bynaturedesign.ca

ByNature Import Inc.
490-1000 Parker St
Vancouver, BC V6A 2H2
1.855.436.2919
info@bynaturedesign.ca

bynaturedesign.ca